



Recording Information

- Application Approval Date 7/12/23
Appeal Period Expires 7/27/23
Zoning District AR-3
Permit Number BP-016-23

G			
Check box(es) which describe proposed use or construction (circle choice in parenthesis)			
N = New A = Addition R = Remodel			
Residential:	N	A	R
Single Family	<input checked="" type="checkbox"/>	<input type="checkbox"/>	<input type="checkbox"/>
Two-family (Duplex)	<input type="checkbox"/>	<input type="checkbox"/>	<input type="checkbox"/>
Multi-family	<input type="checkbox"/>	<input type="checkbox"/>	<input type="checkbox"/>
Condominium / Townhouse	<input type="checkbox"/>	<input type="checkbox"/>	<input type="checkbox"/>
Manufactured Home	<input type="checkbox"/>	<input type="checkbox"/>	<input type="checkbox"/>
Seasonal Camp	<input type="checkbox"/>	<input type="checkbox"/>	<input type="checkbox"/>
ADU (accessory dwelling unit)	<input type="checkbox"/>	<input type="checkbox"/>	<input type="checkbox"/>
Inclusions or Additions:			
Garage <input type="checkbox"/> attached <input type="checkbox"/> detached Addition	<input type="checkbox"/>	<input type="checkbox"/>	<input type="checkbox"/>
Porch <input type="checkbox"/> enclosed <input type="checkbox"/> open	<input type="checkbox"/>	<input type="checkbox"/>	<input type="checkbox"/>
Deck / Patio	<input checked="" type="checkbox"/>	<input type="checkbox"/>	<input type="checkbox"/>
Pool <input type="checkbox"/> in ground <input type="checkbox"/> above	<input type="checkbox"/>	<input type="checkbox"/>	<input type="checkbox"/>
Shed / Play House / Coop	<input type="checkbox"/>	<input type="checkbox"/>	<input type="checkbox"/>
Barn <input type="checkbox"/> residential <input type="checkbox"/> agriculture	<input type="checkbox"/>	<input type="checkbox"/>	<input type="checkbox"/>
Greenhouse <input type="checkbox"/> residential <input type="checkbox"/> agriculture	<input type="checkbox"/>	<input type="checkbox"/>	<input type="checkbox"/>
Fence (< 5' in height no permit required)	<input type="checkbox"/>	<input type="checkbox"/>	<input type="checkbox"/>
<input type="checkbox"/> Other: _____			
Non-Residential:			
Commercial / Industrial	<input type="checkbox"/>	<input type="checkbox"/>	<input type="checkbox"/>
Sign	<input type="checkbox"/>	<input type="checkbox"/>	<input type="checkbox"/>
Other:	check if needed		
Change in Use	<input type="checkbox"/>		
Home Occupation	<input type="checkbox"/>		
Permit Renewal Appeal	<input type="checkbox"/>		
Variance / Waiver	<input type="checkbox"/>		

D	Previous Permits / Subdivision Name / Driveway Permit / DRB Application
	_____/_____ _____/_____

VT Building Energy Standards Certificate (RBES): *The Vermont Residential Building Energy Standard (RBES) - 30 V.S.A. § 51 affects all new homes built after July 1, 1998. It is the energy code for all residential buildings 3 stories or less above grade in Vermont. RBES Disclosure Statement must be filled out and recorded with the town prior to the issuance of a Certificate of Occupancy. Applicant must certify the following:*

☐ Structure which is subject of this application DOES NOT require an RBES Certificate

☒ Structure which is subject of this application DOES require an RBES Certificate

Property Owner Acknowledgement: *The undersigned applicant hereby affirms that the information provided in this application is true, accurate, and complete. I understand if this application is approved, I must post the building poster provided on the property in public view and allow a 15 day appeal period before work begins. I understand Vermont law allows 30 days to find this application complete. I understand that my signature on this application constitutes permission for on-site inspection of the property described on this application form under Article 3 of the Georgia Development Regulations.*

Applicant Signature _____ **Date** 2/12/23 **Co-Applicant Signature:** _____ **Date** ____/____/____

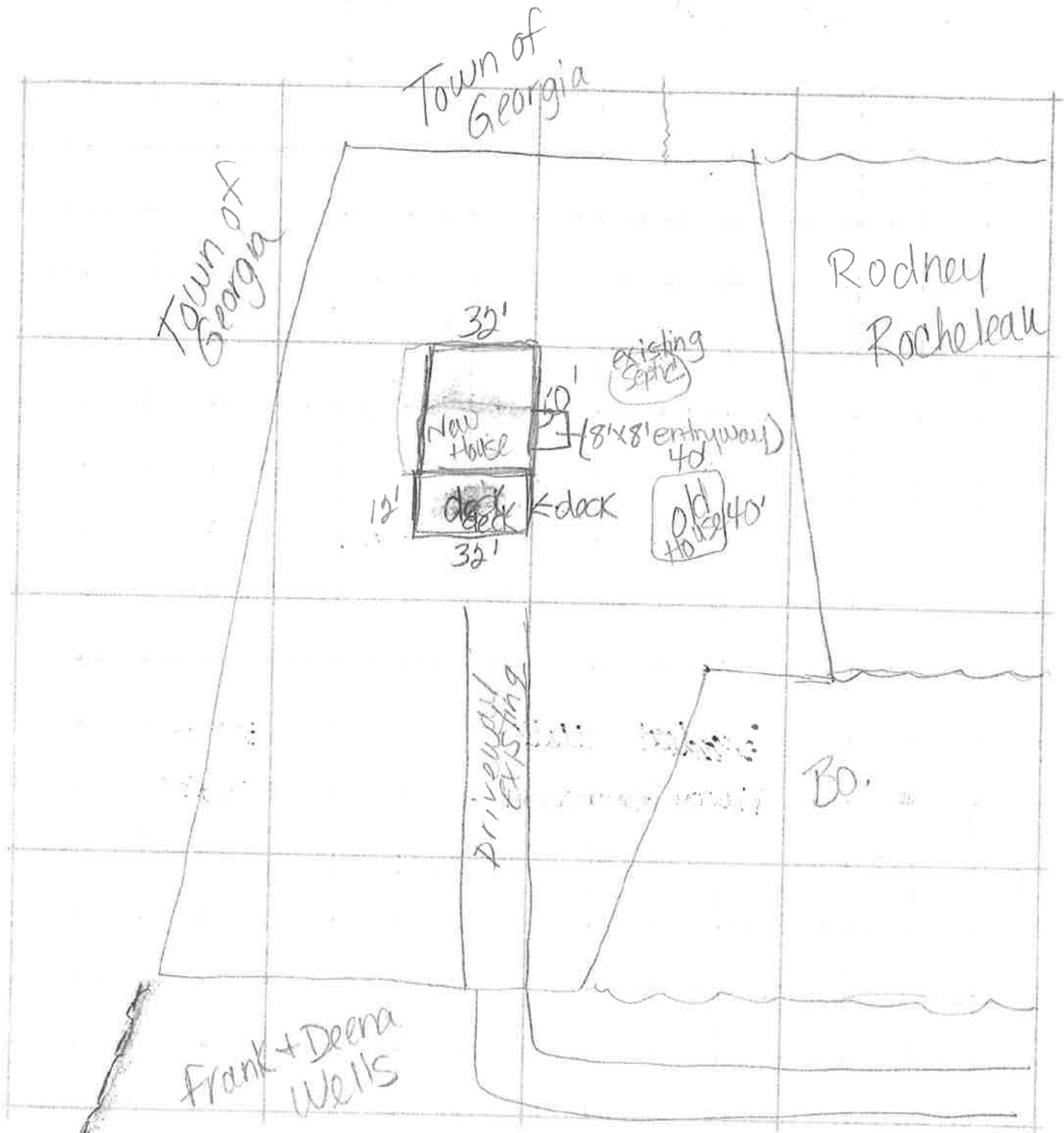

Provide drawing of proposed improvements as follows:

- 1) Draw sketch of lot showing lengths of front, side and rear property lines and location of Public Highway(s). Also draw an arrow indicating North.
 - 2) Draw sketch of existing and proposed buildings or improvements with dimensions and show distance to property lines & center line of road)
 - 3) Draw location of septic system (existing or proposed)
 - 4) Write names of adjacent property owners next to appropriate property lines and across the road.
 - 5) Show location of existing or proposed driveway.
 - 6) Is the property owner the owner of adjoining property?
- Note: You may submit blueprints or other engineered drawings in lieu of this sketch.

Note: The applicant retains the obligation to identify, apply for, and obtain relevant state permits for this project. Call (802)477-2241 to speak with a regional Permit Specialist.